

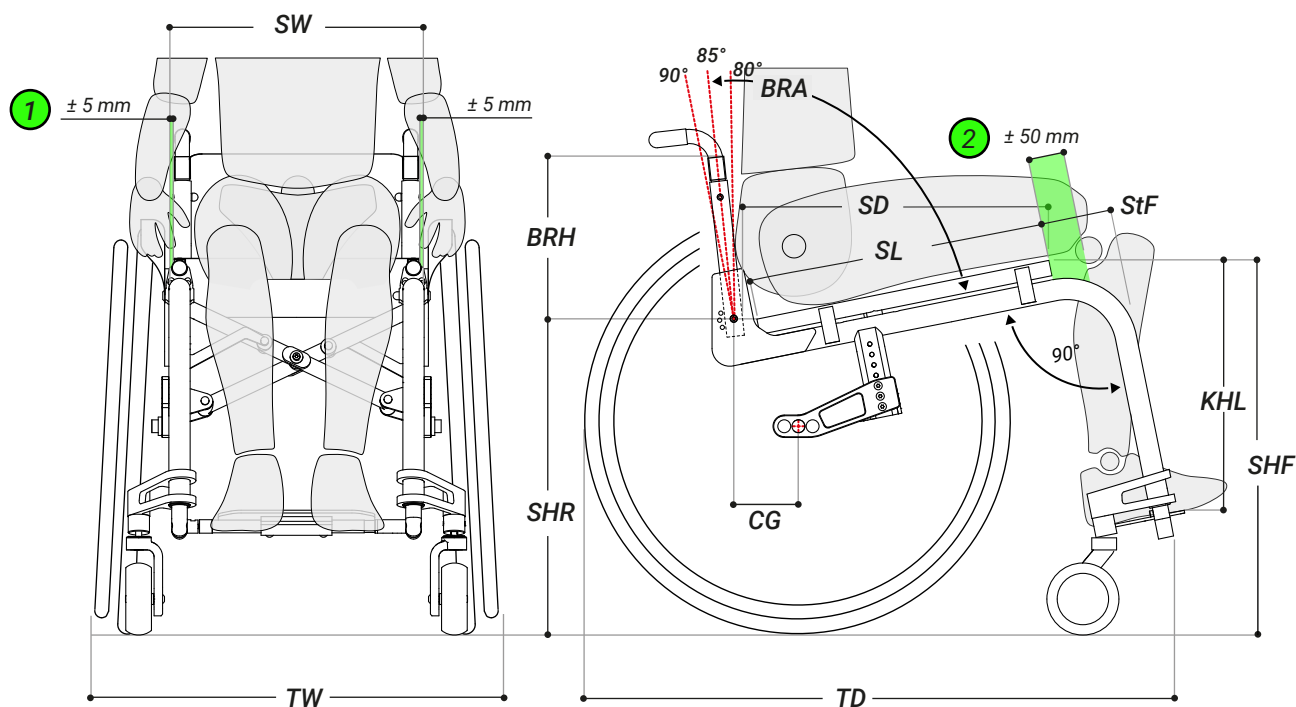

FLIX

TECHNICAL SCHEME



The technical scheme do not consider the dimensions of any postural and anti decubitus cushions.

SW: Considered external tube to external tube of the frame. The dimension between the internal faces of the side guards is + 10 mm than the SW

SD: Considered the depth of the seat. It considers the dimension from the end of the seat to the back tube.

SL: Considered the length of the seat pan. SL = SD - 20mm

CG: Considered from the backrest foam to the axle of the rear wheels.

SHF e SHR: The height of the front and rear seat can be adjusted by 15 mm after sales by authorised staff, following the manufacturer's instructions.

BRH: Considered from the seat to the top of the backrest.

TOLERANCE: The product is manufactured with a tolerance of ± 5 mm

For a right sizing of the wheelchair is recommended:

① SW | Seat Width _ A space of ± 5 mm between the user basin and the side guards.

② SD | Seat Depth _ A space of ± 50 mm between the user's popliteal fossa and the rigid carbon seat.



SW: 340 – 460 mm
in increment
of 20 mm



SD: 380 – 480 mm
in increment
of 20 mm



BRH: 240 – 405 mm
in increment
of 15 mm



SHR: 390 - 450mm
in increment
of 15 mm



SHF: 425 – 530 mm
in increment
of 15mm



KHL:
min = SHF - 145mm
max = SHF - 25mm
in increment of 15mm



CG:
prudent 85mm
standard 105mm
active 125mm



BRA:
80° - 85° - 90°
compared to the
seat surface



CRW:
0° or 3°



StF:
100 mm (SD400-440-480)
120 mm (SD380-420-460)



TOTAL WIDTH in use (TW)
(Camber 0°) SW+190mm
(Camber 3°) SW+235mm



TOTAL DEPTH (TD)
STF + SD + 245 +
(100-CG)



TRANSPORT WEIGHT
(Without rear wheels)
 ± 7.8 kg*



**MAXIMUM
USER WEIGHT:**
120 Kg



TOTAL WIDTH close (TWclose)
(Camber 0°) 350 mm
(Camber 3°) 370 mm

ARIA WHEELS SRL

Registered Office_Via della Divisione Torino, 92 00143 Roma - Italy

Production Dept_Via A. Volta, 7/B 36030 Costabissara (VI) - Italy

VAT IT 12848301003 | tel.+39 0444701414

www.ariawheels.com | info@ariawheels.com